

Boozter™

User's Guide



/// ROXELL®

TABLE OF CONTENTS

GENERAL INFORMATION	2
1. OBEY THE LEGAL REGULATIONS AND THE APPLICABLE RULES!	2
2. INTENDED USE	2
3. NOT-INTENDED USE	2
4. LIABILITY	2
5. PERSONNEL QUALIFICATIONS	2
6. INFORMATION ABOUT THE RESIDUAL RISKS - USED SAFETY SIGNS	3
7. STORAGE	3
8. TRANSPORT	3
9. DISMANTLING	4
10. THE LEVEL OF NOISE EMISSION	4
11. LOCK OUT TAG OUT – LOCK METHOD GENERAL	4
12. USE PERSONAL PROTECTIVE EQUIPMENT.	4
13. SUFFICIENT LIGHTING - ILLUMINANCE	4
14. ELECTRICAL EQUIPMENT, CONTROL PANELS, COMPONENTS AND DRIVE UNITS .	4
GENERAL SAFETY RULES	5
OPERATOR'S GUIDE	6
MAINTENANCE INSTRUCTIONS	7
TROUBLE SHOOTING GUIDE	8
DAILY WINCHING	10
GENERAL SAFETY RULES	10
TROUBLE SHOOTING GUIDE	11
DECLARATION OF INCORPORATION OF PARTLY COMPLETED MACHINERY	
EC-DECLARATION OF CONFORMITY	

DISCLAIMER : The original, authoritative version of this manual is the Dutch version produced by Roxell bvba. Subsequent changes to any manual made by any third party have not been reviewed nor authenticated by Roxell. Such changes may include, but are not limited to, translation into languages other than Dutch, and additions to or deletions from the original content. Roxell disclaims responsibility for any and all damages, injuries, warranty claims and/or any other claims associated with such changes, inasmuch as such changes result in content that is different from the authoritative Roxell-published Dutch version of the manual. For current product installation and operation information, please contact the customer service and/or technical service departments of Roxell. Should you observe any questionable content in any manual, please notify Roxell immediately in writing to: Roxell bvba - Industrielaan 13, 9990 Maldegem - Belgium.

GENERAL INFORMATION

THESE INSTRUCTIONS MUST BE READ, UNDERSTOOD AND ALL POINTS OBSERVED BY THE USER, THE RESPONSIBLE AND OPERATING PERSONNEL.

1. OBEY THE LEGAL REGULATIONS AND THE APPLICABLE RULES!

This concerns, among other things, the European directives transposed into national legislation and/or the laws, safety and accident prevention regulations that apply in the user's country.

During assembly, operation and maintenance of the installation the legal regulations concerned and the applicable technical rules must be obeyed.

2. INTENDED USE

The installation has been designed solely for intensive livestock use and has been developed according to the applicable rules of good workmanship. Extra loading of the product is therefore prohibited. Any other use is considered to be improper use. The manufacturer is not responsible for damage resulting there from. The user bears sole responsibility.

3. NOT-INTENDED USE

All use different than described in point 2" intended use" is at the responsibility of the end user.

4. LIABILITY

The (Extended) Warranty will not apply if any of the following has occurred: failure to conduct incoming goods inspection with regards to the Products, improper handling, transportation, modification or repair; accident, abuse or improper use; improper assembly, installation, connection or maintenance (having regard to Roxell's most current assembly, installation, connection and maintenance manuals); force majeure; negligence, lack of supervision or of maintenance on the part of customer; normal wear and tear; use of cleansing agents and disinfectants that are excluded in Roxell's most current use and maintenance manuals; use of cleansing agents and disinfectants in violation with the instructions received from the suppliers; or use of the Products in an ATEX-surrounding.

The (Extended) Warranty shall not apply in the event of a defect caused either by materials or accessories supplied by or services rendered by Customer, or by an intervention by a person or entity which is not authorised or qualified for carrying out such intervention. Furthermore, the (Extended) Warranty will only apply if the Products are used in livestock houses and if all parts or components of the Products are supplied by Roxell.

Roxell will not be liable for any damages caused due to improper use, assembly, installation, connection or maintenance of the Products. In this respect, the Customer expressly acknowledges that (i) all use, assembly, installation, connection or maintenance must be done in accordance with Roxell's most current assembly, installation, connection and maintenance manuals and (ii) the electrical installation on which the Products must be connected must be done in accordance with applicable local legislation on electrical installations. Furthermore, the Products must be tested both mechanically and electrically in accordance with state of the art techniques and applicable local legislation.

5. PERSONNEL QUALIFICATIONS

USER:

The person who uses a function or operation of a product for their work or who works on the product. The user must be able to read the instructions for use and fully understand them. The user has knowledge of the functioning and construction of the installation.

TECHNICALLY TRAINED PERSON:





An expert who can assemble and maintain the installation (**mechanically/electrically**), and resolve malfunctions. On the basis of his/her technical training and experience, he/she has sufficient knowledge to be able to assess activities, recognise possible dangers and rectify dangerous situations.

6. INFORMATION ABOUT THE RESIDUAL RISKS - USED SAFETY SIGNS

There are three levels of danger, which you can recognize from the signal word

- * **DANGER**
- * **WARNING**
- * **CAUTION**

The nature and source of the imminent danger and possible consequences of not obeying warnings is stated here!

 DANGER	<p>DANGER indicates a direct imminent danger that can result in a serious or even fatal accident if the safety measures are not respected.</p>
 WARNING	<p>WARNING indicates a possible imminent danger that can result in a serious accident or damage to the product if the safety measures are not respected.</p>
 CAUTION	<p>CAUTION indicates possible, dangerous situations that can result in minor physical injury or material damage if the safety measures are not respected.</p>
	<p>This symbol refers to supporting information.</p>
<p> <input checked="" type="checkbox"/> allowed <input type="checkbox"/> not allowed </p>	

7. STORAGE

Put all parts to be assembled in a room or at a location where the not yet assembled components are protected against weather influences.

8. TRANSPORT

Depending on the size of the parts and according to local circumstances and local legislation, the parts of the machine have to be transported with a forklift.

The forklift must be operated by a qualified person and in accordance with the rules of good workmanship.

When lifting the load, always check if the center of gravity of the load is stable.

9. DISMANTLING

Dismantle the installation and its components in accordance with the environmental legislation of the country or the local authorities applicable at that time. All functioning products and exchange parts must be stored and disposed of in accordance with the applicable environmental regulations.

Environmental information for customers in the European Union



European directive 2002/96/EC amended by the Directive 2008/34/EC requires that equipment that bears this symbol on the product or packaging must not be disposed of with unsorted household waste. This symbol indicates that the product must be disposed of separately. You are yourself responsible for the destruction of this and other electrical and electronic equipment via the disposal channels designated for that purpose by the national or local government. The correct destruction and recycling of this equipment prevents any negative consequences for the environment and health. For more information about destroying your old equipment, contact your local authorities or waste disposal service.

Information about waste disposal - electrical/electronic material for companies

1. In the European Union

If you have used the product for commercial purposes and you want to dispose of it, contact Roxell who will give you information about the return of the product. It is possible that you will have to pay a disposal charge for the return and recycling. Small products (and small quantities) can be processed by the local collection agencies.

2. In other countries outside the European Union

If you want to dispose of this product, contact the local authorities for information concerning the correct disposal procedure.

10. THE LEVEL OF NOISE EMISSION

The noise level of the installation in operation does not exceed 70dB(A).

11. LOCK OUT TAG OUT – LOCK METHOD GENERAL

- Everyone needs his own lock and tag (label), which can't be removed by other persons.
- Inform all persons who are influenced by the procedure.
- Localize all sources of energy (electric, hydraulic, pneumatic).
- Switch off.
- Lock out and tag out.
- Check if the source of energy is switched off.
- Remove any remaining energy.

12. USE PERSONAL PROTECTIVE EQUIPMENT.

Ensure you wear personal protective equipment (gloves, dust masks...).

13. SUFFICIENT LIGHTING - ILLUMINANCE

- **A minimum illuminance of 200 lux is necessary** during usage, maintenance and installation.
- Provide at the installation **(portable) emergency lighting in case of power failure.**

14. ELECTRICAL EQUIPMENT, CONTROL PANELS, COMPONENTS AND DRIVE UNITS

- To operate control panels, there must be **at least 70 cm of free space.**
- Control panels must **always remain closed.** The key of the control panel must be in possession of an authorized person.
- The necessary measures must be taken by the user to keep out **rats, mice and other vermin from the control panels**
- If electrical equipment, control panels, components and drive units are damaged, the system must be stopped **IMMEDIATELY!**
- Electrical equipment, control panels, components and drive units should **NEVER be sprayed with water or other liquid!**
- Electrical equipment, control panels, components and drive units should **NEVER be covered with any material.**

GENERAL SAFETY RULES

KiXoo/Vitoo/Boozzter Nr: 008.../008.../002...

Automatisch pannen voedersysteem voor opfok en productie van slachtkuikenouderdieren.

Automatic pan feeding system for rearing and production of broiler breeders.

Winching systeem

Liersysteem voor voer- en drinklijnen

Winching system for feed and drink lines



DANGER

IMPORTANT

Carefully read the following instructions before USING the system

1. Before you do any **repair**, or **maintenance works**, always **disconnect the electricity supply**.
2. Ensure you wear **personal protection equipment** (gloves, dust masks).
3. The system **starts automatically**.
Never use your **hands** at **dangerous locations** (feed intake boots, drive units, control units or outlet holes in the tubes) before you have **completely switched off** the transport system and made sure that **nobody** can **switch it on** without your knowledge.
4. **Never** allow **unauthorized persons** to **enter the house** in your absence.
5. **Be careful** when **lowering** or **winching** up the feeding lines/circuits :
 - **stop** immediately at the slightest hitch.
 - **never** stay **underneath** when lowering or winching up the lines/circuit.
6. If the auger stalls : **immediately** switch **off** the system. Carefully read the trouble shooting guide and strictly follow instructions. Contact a **technically trained person**.
An auger **under tension** can **cause very serious injuries** when released.
7. Regularly check the **elbow/trough and/or tube connections**. Tighten if necessary.
8. Regularly check that the **control unit (pan)** and/or the **motor handy box** are properly closed.
9. Ensure that the **hopper cover grill or cover** on the 100 kg hopper **closes properly**.
10. The standard winching system is **only suitable for height regulation** during the flock's stay and **winching up for cleaning** (1x per flock). For more frequent winching, use the **daily winching components**.



This **SYMBOL** will be used to draw your attention to matters that are of **GREAT IMPORTANCE** for your **SAFETY**.

It means : **WARNING** - follow the safety instructions : disconnect the current - re-read the safety rules.

In short : **BE ALERT**. **IGNORING** these instructions can cause **SERIOUS INJURIES** or even **DEATH**.

6 WAYS TO GET A BETTER UNIFORMITY :

- 1 Keep the number of birds/pan constant (10 animals/pan).
Use the shut-off-shell when removing pans from the system (< 10 animals/pan = remove pans).
- 2 Keep the pans at the correct height : allow all the cockerels to eat .
- 3 Keep the litter in good shape and level and remove superfluous/dirty litter.
- 4 Take care that all the lines are suspended perfectly level.
- 5 Adjust the eating speed by turning the adjuster ring. An eating time of 25 till 45 minutes is recommended.
The most common position of the adjuster ring is between 6 and 12.
- 6 Only start to feed the cockerels when all the females have access to their feed.

Keep the Boozzter pans slightly higher than the back of the males. →

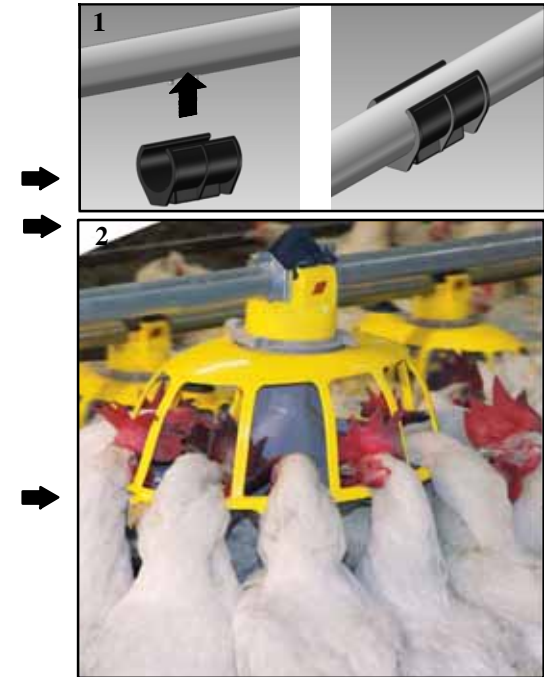

Poultry perch system



- do not use it constantly
- use as WARNING !

CLEANING

- * The last day : run the tubes empty and let the birds empty the pans as much as possible.
- * Collect the feed residues by opening all pans, and empty them.
- * Protect electrical components against water.
- * Clean the whole system by means of a high-pressure cleaner (max. 100 Bar).
- * When using aggressive detergents or disinfectants consult your supplier.

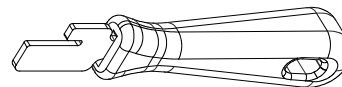

09701863 OPENING TOOL BOOZZTER PAN

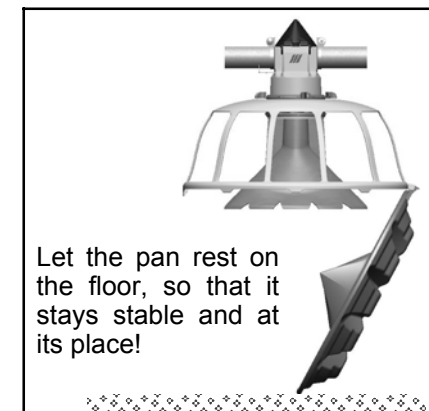
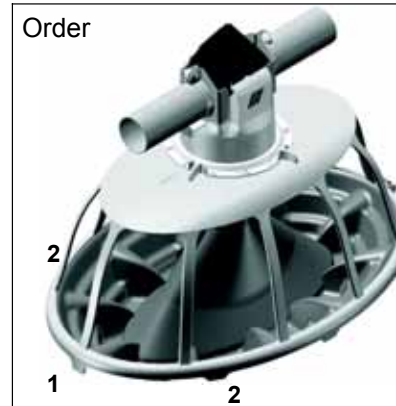

MAINTENANCE INSTRUCTIONS				
 DANGER	Switch off the main switch first. Use personal protective equipment.	3-monthly	6-monthly	Yearly
ACTIONS IN GREY BACKGROUND MUST BE DONE BY A TECHNICALLY TRAINED PERSON.				
1. Power unit				
- Make fan dust-free				X
- Check possible damages to electrical wiring				X
2. Drive unit (circuits)				
- Make fan dust-free		X		
- Check possible damages to electrical wiring				X
- Clean gear housing				X
3. 100kg hopper (lines)				
- Check level switch				X
4. Suspension				
- Check operation of (central) winch	X			
- Check operation of (central) winch. Grease after cleaning.				X
- Check connection of cable	X			
- Check connection of pulleys	X			
- Check suspension of tubes and motors	X			
- Keep suspension cord/cable in tension	X			
5. Poultry perch cable above the tubes/elbows				
- Check cable				X
6. Pans				
- Check possible damages of pans				X
7. Sensors/switches				
- Check operation of safety switch or sensor.		X		
- Check electrical wiring				X
8. Feed intake boot				
- Clean				X
- Check possible wear of plastic gear				X
9. Lines/circuits				
- Check screws and bolts in the system after the first month and after each batch . Tighten if necessary.	X			
- Keep tubes level.	X			
- Remove all feed from the system when the system will be out of use for a period.	X			

TROUBLE SHOOTING GUIDE



**Switch off the main switch first.
Use personal protective equipment.**

DANGER

ACTIONS IN GREY BACKGROUND MUST BE DONE BY A TECHNICALLY TRAINED PERSON.

FOR ANY AUTOMATIC OPERATION, NONE OF THE YELLOW LAMPS SHOULD BURN !

PROBLEM	YELLOW LAMP	CAUSE	CORRECTIVE ACTION
1. None of the feeder lines run.	NO	No current.	Check main switch and/or fuses and/or line current.
2. FA bin to weigher does not run	NO	a. Operation button not on "ON" position.	Adjust button.
	NO	b. Max. switch of weigher remains activated.	Check Max. switch and repair or replace it if necessary.
		c. FA safety switch is activated.	Disengage safety switch and find cause of blockage.
	YES	d. Thermal-magnetic switch-off of the FA.	Check fuses. Check adjustment of motor protection. Reload motor protection and check its proper operation.
3. FA weigher to circuits does not run.	NO	a. See 2.a.	
		b. Sensor remains activated. See signal lamp sensor.	Check and repair.
	NO	c. See 2.b. and 2.c.	
	YES	d. See 2.d.	
4. FA weigher to circuits short cycles	NO	a. Sensor not properly installed.	Check.
		b. Timer of sensor adjusted too low.	Adjust timer on a higher value.
5. The circuit does not run.	NO	Wrong programming of time clock or counter or no programming at all.	Check programming.
	YES	a. Left or right hand motor of one or more circuits switched-off without being overloaded.	Check fuses. Check adjustment of motor protection. Reload motor protection and check its proper operation.
	YES	b. Left or right hand motor of one or more circuits switched-off thermal-magnetically (overloaded).	
		1. Too much feed in the tubes. 2. Connector intake boot/tube or tube-elbow not properly tightened. 3. Auger coupling not properly installed.	Have pans emptied by the birds. Check the operation of the sensor in the control pan. Tighten connector correctly. Check auger couplings and replace if necessary.

PROBLEM	YELLOW LAMP	CAUSE	CORRECTIVE ACTION
		4. Auger kinked . 5. Wheel inside intake boot is blocked. 6. Obstruction in the tube.	Replace damaged auger. Disengage wheel or replace if necessary. Find blocking spot and remove the obstruction. SEE NOTE* .



DANGER

NOTE : IF THE AUGER OF THE CIRCUIT IS BLOCKED AS A RESULT OF ONE OF THE ABOVE PROBLEMS, IT WILL BE UNDER SPRING TENSION, SO BE EXTREMELY CAREFUL AND PROCEED AS DESCRIBED BELOW THIS PAGE*

6. The circuit : - stops prematurely - does not stop in time.		a. Time set on time clock is not sufficient.	Adjust time clock programming.
		b. The sensor in the control pan is defective or not properly adjusted.	Check the sensor operation and replace if necessary
7. Auger runs erratically.		a. When using the system for the first time.	This is not a breakdown; it will be ok after a couple of days.
		b. Auger too short.	Adjust auger length.
		c. Auger kinked as a result of careless installation.	Replace kinked parts.
		d. Auger coupling not properly installed.	See installation instructions. Replace coupling if necessary.
		e. Circuit too long.	Check maximum length and install an extra power unit if necessary.
		f. Circuit not properly suspended (loose or ineffective suspension).	Realign circuit. Check all suspensions and readjust where needed.



DANGER

SWITCH OFF THE MAIN SWITCH OF THE CENTRAL CONTROL PANEL BEFORE YOU PROCEED WITH MANUAL CHECKS OR REPAIRS OF AUGERS OR POWER UNITS !

*** WHEN THE AUGER IS BLOCKED, PROCEED AS FOLLOWS :**

1. Put the main switch in position "Off".
2. Locate the blocking spot precisely.
3. Reload the motor protection (left or right).
4. Find the cause and correct. (See page 8 : 3., 4., 5. or 6.).
5. Put main switch in position "ON". The circuit is ready for a new feeding cycle.

DAILY WINCHING

GENERAL SAFETY RULES

Dagelijks lieren voor pluimvee

Daily winching for poultry

IMPORTANT

Carefully read the following instructions before
USING the system



DANGER

1. **PAY ATTENTION** when **WINCHING UP** or **PUTTING DOWN** the poultry lines:
 - **STOP** the handling in case of any malfunctioning.
 - **NEVER** stand **UNDERNEATH** the load when winching up or putting down the poultry lines.
2. **NEVER ALLOW UNAUTHORIZED PERSONS ENTER** the house during your absence.
3. **DON'T** wear **loose** clothing.
4. Only **adults** may control the motorized winch.
5. Only use the motorized winch for **suspension of a ROXELL poultry line and circuits**.
6. **ALWAYS** check the **condition of the motorized winch and the cable** before operating.
A **ravelled, kinked or damaged cable** must be replaced **IMMEDIATELY**.
A **loose or damaged daily winch** must be replaced **IMMEDIATELY**.
7. **ALWAYS** check before use, if the **cable** is ok.
8. **ALWAYS** check before use, if the **cable is not damaged**.
9. **NEVER** touch the **cable**, the **rotating parts** of the motorized winch and the **switches** of the switch assembly for automatic winch, when in use.
10. Only use the motorized winch when **NOBODY** is standing **underneath the load**.
11. **ALWAYS** look **at the load** while using the motorized winch in **manual mode**.
12. **PREVENT** that the load makes a **shocking movement**.
13. **COVER** the motorized winch during **cleaning**.



FORBIDDEN: NEVER use the motorized winch to lift persons.



DANGER: Getting jammed may cause **SERIOUS INJURIES**.

DAILY WINCHING

TROUBLE SHOOTING GUIDE

Not respecting above-mentioned instructions can cause physical injury or material damage.

Switch off the main switch first.

Use personal protective equipment.



DANGER

ACTIONS IN GREY BACKGROUND MUST BE DONE BY A TECHNICALLY TRAINED PERSON.



DANGER

SEE TO IT THAT YOU FIRST REMOVE EACH ELEMENT WHICH CAN OBSTRUCT A SAFE OPERATION OF THE SYSTEM!

PROBLEM	CAUSE	CORRECTIVE ACTION
1. Sensor doesn't work.	a. Defect of sensor.	- Replace the sensor.
	b. No power supply to sensor.	- Restore power supply. - When not ok , please ask a technically trained person.
	c. The housing is dirty.	- Clean the motorized winch dry. - When not ok , please ask a technically trained person.
2. Winching up doesn't work.	a. Load is too heavy.	- Limit the load till max. 300 kg.
	b. Cable to load is blocked somewhere.	- Release the cable.
	c. Motor is broken.	- Replace motor.
	d. Weight assembly is touching cleaning switch.	- Winch can only go down.
	e. Drop tubes to circuits are full.	- Empty drop tubes manually.
3. Putting down the load doesn't work.	a. Cable to load is blocked somewhere.	- Release the cable.
	b. Feeding switch is touched.	- Winch can only go up.
4. Motor doesn't work.	a. Motor is overloaded.	- Check CCP/motor.
	b. Motor is too warm.	- Check motor.
5. Cable is damaged.	a. Cable touches material.	- Replace the cable and prevent wearing over hard material.
	b. Suspension should be done with single/double diversion.	- Change suspension.

MAINTENANCE INSTRUCTIONS



DANGER

**Switch off the main switch first.
Use personal protective equipment.**

- Remove all dirt and dust after each batch or at least every 6 months.
- See to it that the winch turns fluently on the screw thread of the main shaft.
- Don't use water to clean the motorized winch.
- Use grease to grease moving parts.
- Check suspension cable each batch or every 6 months.
- Check the feed/fill/clean switches of the switch assembly.
- Grease switch assembly and sliding plate.
- Remove dust and dirt from the switch assembly for motorized winching.



Inbouwverklaring betreffende niet voltooide machines (*Richtlijn 2006/42/EG, Bijlage II.1.B*)
Declaration of incorporation of partly completed machinery (*Directive 2006/42/EC, Annex II.1.B*)

Fabrikant/Manufacturer:
Roxell, Industrielaan 13, 9990 Maldegem
Tel: +32 50 72 91 72
Fax: +32 50 71 67 21

Verklaart geheel onder eigen verantwoordelijkheid dat het product:
Declares on its own responsibility that the product:

KiXoo/Vitoo/Boozster Nr: 008.../008.../002...
Automatisch pannen voedersysteem voor opfok en productie van vleeskuikenouderdieren.
Automatic pan feeding system for rearing and production of broiler breeders.

Waarop deze verklaring betrekking heeft, in overeenstemming is met:

- de volgende richtlijnen: 2006/42/EG (Machinerichtlijn); 2014/30/EU (Elektromagnetische Compatibiliteit).
- de geharmoniseerde Europese Normen: EN ISO 13857:2008; EN 349:1993 + A1:2008; EN ISO 12100:2010; EN 60204-1:2006; EN 61439-1:2011; EN 61439-2:2011

Het is verboden bovengenoemd product in gebruik te stellen voordat de machine waarin het wordt ingebouwd in overeenstemming met de bepalingen van de Machinerichtlijn is verklaard.

Tevens verbindt de fabrikant (of zijn gemachtigde) zich om op met redenen omkleed verzoek van de nationale autoriteiten de relevante informatie over deze niet voltooide machine door te geven. De wijze van doorgifte is digitaal. De wijze van informatieverschaffing laat de intellectueel-eigendomsrechten van de fabrikant van de niet voltooide machine onverlet.

(NL)

Relating to this declaration, is conform

- The following directives 2006/42/EC (Machinery Directive); 2014/30/EU (Electromagnetic Compatibility).
- The harmonised European standards: EN ISO 13857:2008; EN 349:1993 + A1:2008; EN ISO 12100:2010; EN 60204-1:2006; EN 61439-1:2011; EN 61439-2:2011

This product must not be put into service until the machinery into which it is to be incorporated has been declared in conformity with the provisions of the Machinery Directive.

The manufacturer (or its agent) also undertakes, at the duly reasoned request of the national authorities, to provide the relevant information concerning this partly completed machinery. The method of transmission will be digital. The manner in which the information is provided does not prejudice the manufacturer's intellectual property rights concerning the partly completed machinery.

(EN)

00802603

Plaats, Datum / Place, Date : Maldegem, 01/01/2017

.....
Dhr. Gino Van Landuyt
Managing Director

“This part may only be filled out if all built-in subparts are delivered by Roxell”

EG-verklaring van overeenstemming (*Richtlijn 2006/42/EG, Bijlage I.1.A*)
EC-declaration of conformity (*Directive 2006/42/EC, Annex II.1.A*)

Wij/We _____
(naam installateur/name fitter)

(volledig adres en land/complete address)

Verklaren geheel onder eigen verantwoording de
Declare completely on own justification that

(naam machine/name machinery) (nummer CE-label/number CE-label)

In een installatie te hebben ingebouwd geheel volgens de Roxell-voorschriften en in overeenstemming met de bepalingen van de Machinerichtlijn.
Has been incorporated in conformity with the provisions of the Machinery Directive and the prescriptions of Roxell bvba.

(plaats, datum/place, date) (naam, handtekening/name, signature)

De EG-verklaring van overeenstemming / inbouwverklaring betreft uitsluitend de machine of niet voltooide machine in de toestand waarin zij op de markt is gebracht, met uitsluiting van de later bijvoorbeeld door de verdeler en/of installateur en/of eindgebruiker toegevoegde componenten en/of verrichte bewerkingen.

The EC-declaration of conformity / declaration of incorporation relates exclusively to the machinery or partly completed machine in the state in which it was placed on the market and excludes components which are added and/or operations carried out thereafter for instance by the distributor and/or the installer and/or the final user.



EG-verklaring van overeenstemming (*Richtlijn 2006/42/EG, Bijlage II.1.A*)
EC-declaration of conformity (*Directive 2006/42/EC, Annex II.1.A*)

Fabrikant/Manufacturer:
 Roxell, Industrielaan 13, 9990 Maldegem
 Tel: +32 50 72 91 72
 Fax: +32 50 71 67 21

Verklaart geheel onder eigen verantwoordelijkheid dat het product:
 Declares on its own responsibility that the product:

Winching system Nr: 00102368 / 00102087
 Liersysteem voor voer- en drinklijnen; manueel en gemotoriseerd
 Winching system for feed- and drink lines; manual and motorised
 Nummer CE-label/number CE-label : _____

Waarop deze verklaring betrekking heeft, in overeenstemming is met:

- de volgende richtlijnen: 2006/42/EG (Machinerichtlijn); 2014/30/EU (Elektromagnetische Compatibiliteit).
 - de geharmoniseerde Europese Normen: EN ISO 13857; EN 349:1993 + A1:2008; EN ISO 12100:2010; gemotoriseerd: EN 60204-1:2006; EN 61439-1:2011; EN 61439-2:2011
- De EG-verklaring van overeenstemming / inbouwverklaring betreft uitsluitend de machine of niet voltooide machine in de toestand waarin zij op de markt is gebracht, met uitsluiting van de later door bijvoorbeeld de verdeler en/of installateur en/of eindgebruiker toegevoegde componenten en/of verrichte bewerkingen.

(NL)

Relating to this declaration, is conform

- The following directives 2006/42/EC (Machinery Directive); 2014/30/EU (Electromagnetic Compatibility).
 - The harmonised European standards: EN ISO 13857:2008; EN 349:1993 + A1:2008; EN ISO 12100:2010; motorised: EN 60204-1:2006; EN 61439-1:2011; EN 61439-2:2011

The EC-declaration of conformity / declaration of incorporation relates exclusively to the machinery or partly completed machine in the state in which it was placed on the market and excludes components which are added and/or operations carried out thereafter for instance by the distributor and/or the installer and/or the final user.

(EN)

Plaats, Datum / Place, Date : Maldegem, 01/01/2017

.....
 Dhr. Gino Van Landuyt
 Managing Director



ROXELL bvba, Industrielaan 13, B-9990 Maldegem (Belgium)
Tel. +32 50 72.91.72 - Fax. +32 50 71.67.21 - E-mail info@roxell.com - Website www.roxell.com

ROXELL Russia, LLC Roxell, Leningradskiy Prospekt 37, bld. 9, premise № 653, 125167 Moscow, Russian Federation -
OGRN : 1157746055026
Tel: +7 495 9833015 - E-mail info.russia@roxell.com - Website www.roxell.com

ROXELL Malaysia - No. 12 Jalan Anggerik Mokara31/48, Kota Kemuning - Industrial Park, 40150 Shah Alam, Selangor,
Malaysia - Tel: +603 5121 7148 or +603 5121 7150 - Fax: +603 5121 7146 - A division of CTB Malaysia Sdn. Bhd.
(868715-X) - E-mail: info.malaysia@roxell.com - www.roxell.com

ROXELL USA, Inc. - 720 Industrial Park Road - Anderson, MO 64831 (USA)
Phone +1 417 845-6065 - Fax. +1 417 845-6069 - E-mail info.usa@roxell.com - Website www.roxell.com